

The Sewing Cube

Storytelling

This project centres around storytelling; the starting point for this design was my dissertation for which I wrote my Granny's biography. Her story is intertwined with many anecdotes about sewing, a skill which I also share with her.

I created illustrations from quotes in this book, which I then embroidered into tapestry. This developed into designing a place where people could go to *share their stories and turn them into tangible artwork to enjoy, exhibit and share.*

In this brief overview of the project you will see how my research led to my final design.

Granny

The Biography of Champaben Dhullabbhai Mistry

I wanted to start by telling you a bit about why I wrote this book, writing Granny's story had always been on my bucket list of things to do. I would always be reminded of this every time I visited her on quiet occasions. These were rare occasions when there was only a few of us or just me at her house; she would open up about her life in Kenya, her childhood experiences, hardships, fond memories and her early life when they moved to England. *What an incredible story, I need to write this up some day.* I would think to myself after scribbling down notes of dates and anecdotes.

Luckily (though not seeming it at the time) some unexpected outcomes of my placement in Barcelona lead me back home to Bradford for a few months. This was when Granny and I spent a lot of time together and I learnt a lot about her life. Alas, I was soon off jet setting again but to Amsterdam to my next placement where I met a lot of interesting people. One lady Annemiek hosted lunch for us most days in the office, she was about the same age as my Granny, but how different their lives had been. Annemiek was single with a 20 year old son and she still travelled the world and volunteered sharing her skills in gardening and cooking.

We had a wonderful time exchanging stories, of her life, my life and my Granny's. I thought *wouldn't it be great if more people could share their stories and their skills.* So I started here by sharing this very special story, and with a vague idea lingering in my mind of designing some sort of community centre where Granny could go to meet people, share her story and her skills.



Annemiek and I on my last week of placement

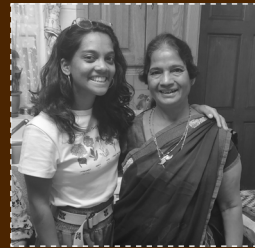

Granny and I photographed on my 22nd Birthday



Granny: The Biography of Champaben Dhullabbhai Mistry

By Chandni Soren

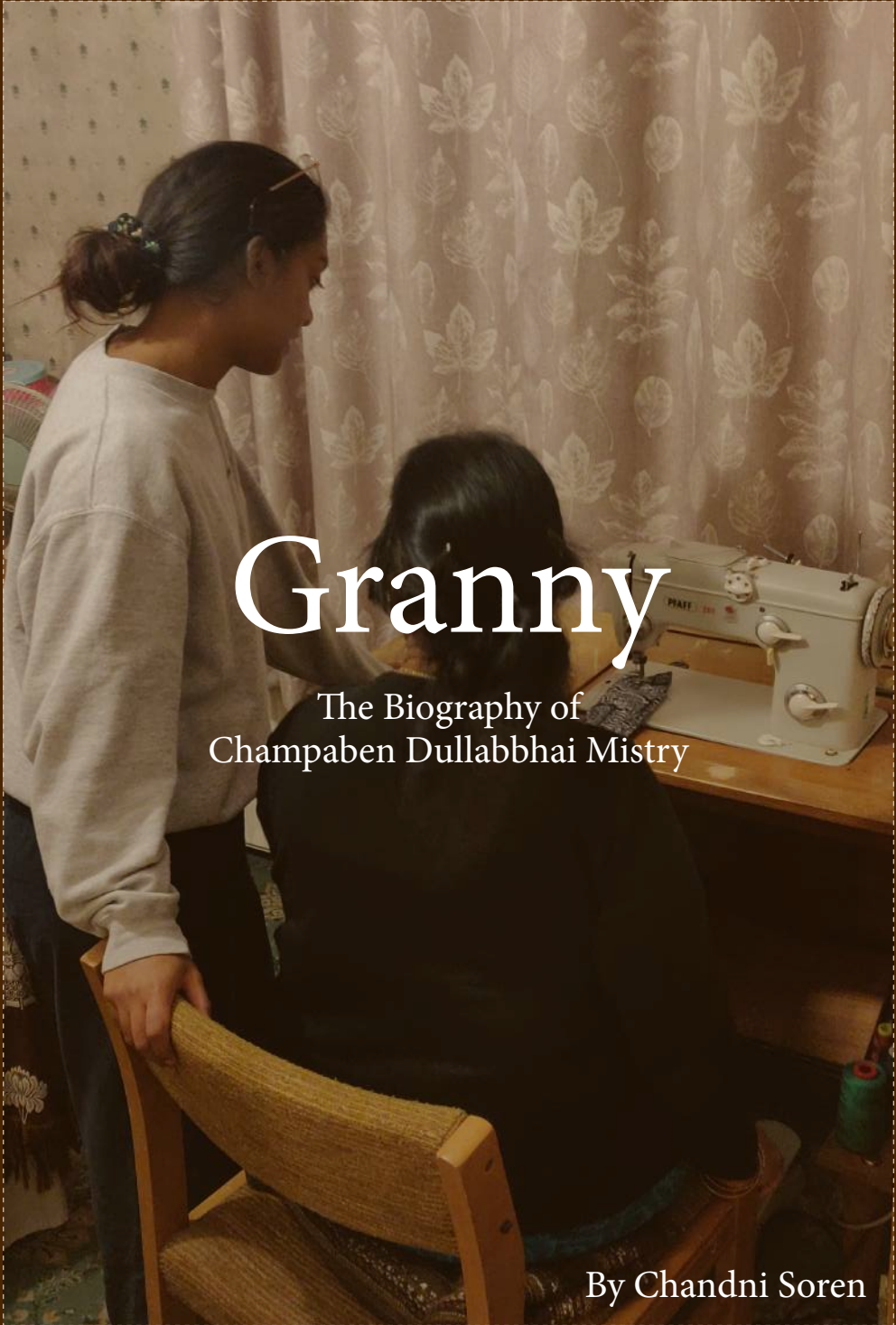

By Chandni Soren



Embroidery Design: Planning & Execution

Quoting memories and stories from my Granny's biography I started to generate images to represent these moments and create a design plan for the embroidery time line.

I used reference images from the family album, images from the internet and my own unique designs to create the sketches. Next I revisited each sketch, refined the design and began sewing it.

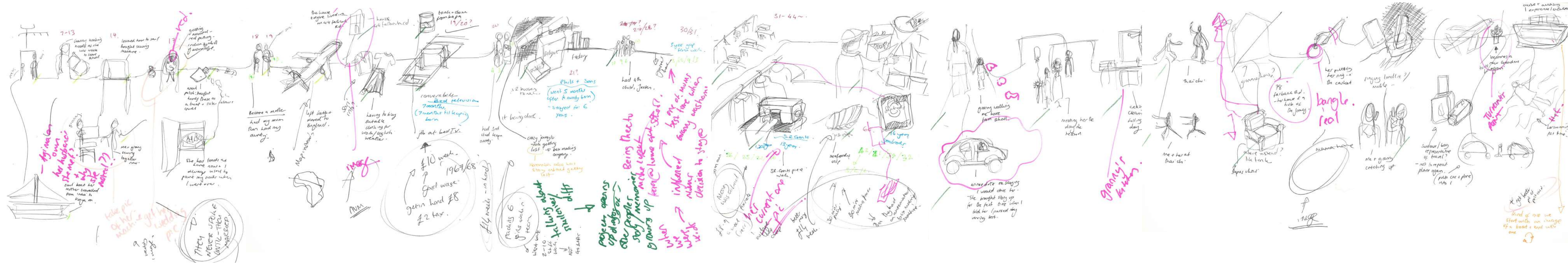

"I often pop round for help to alter my clothes. It is so nice **sharing this skill** with her."

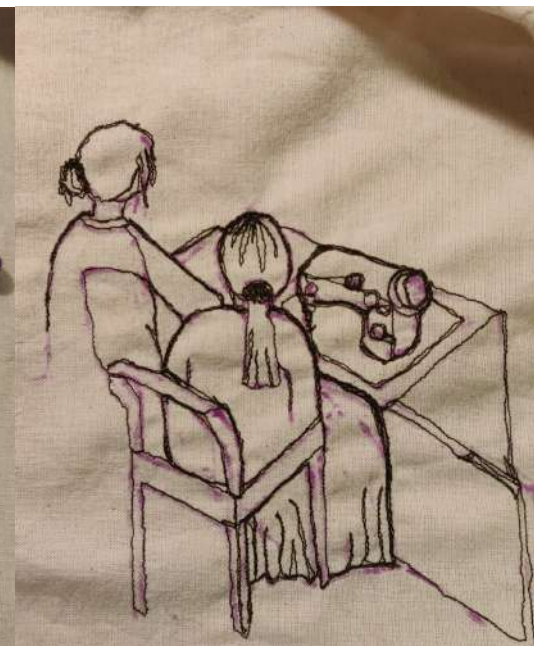
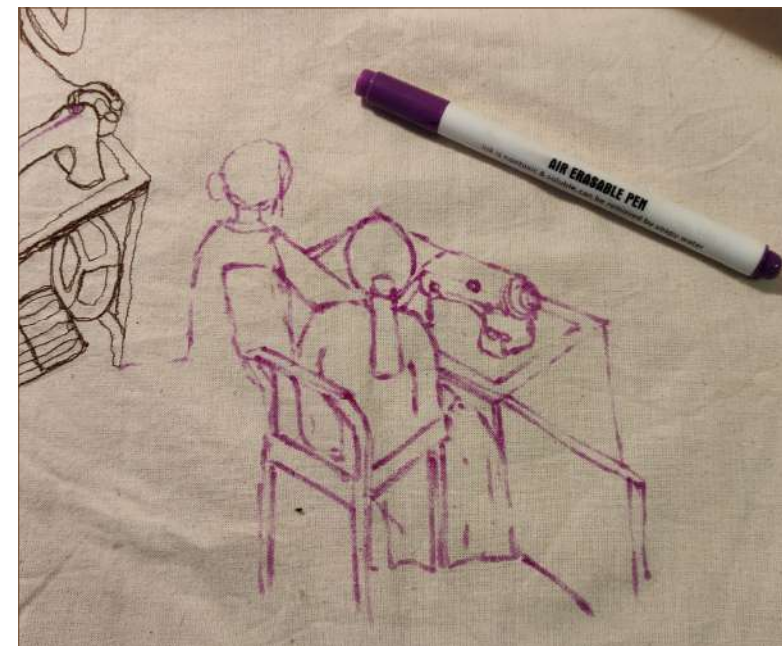

“Granny got married at age 17 to Dullabhai Purshotam Mistry.”



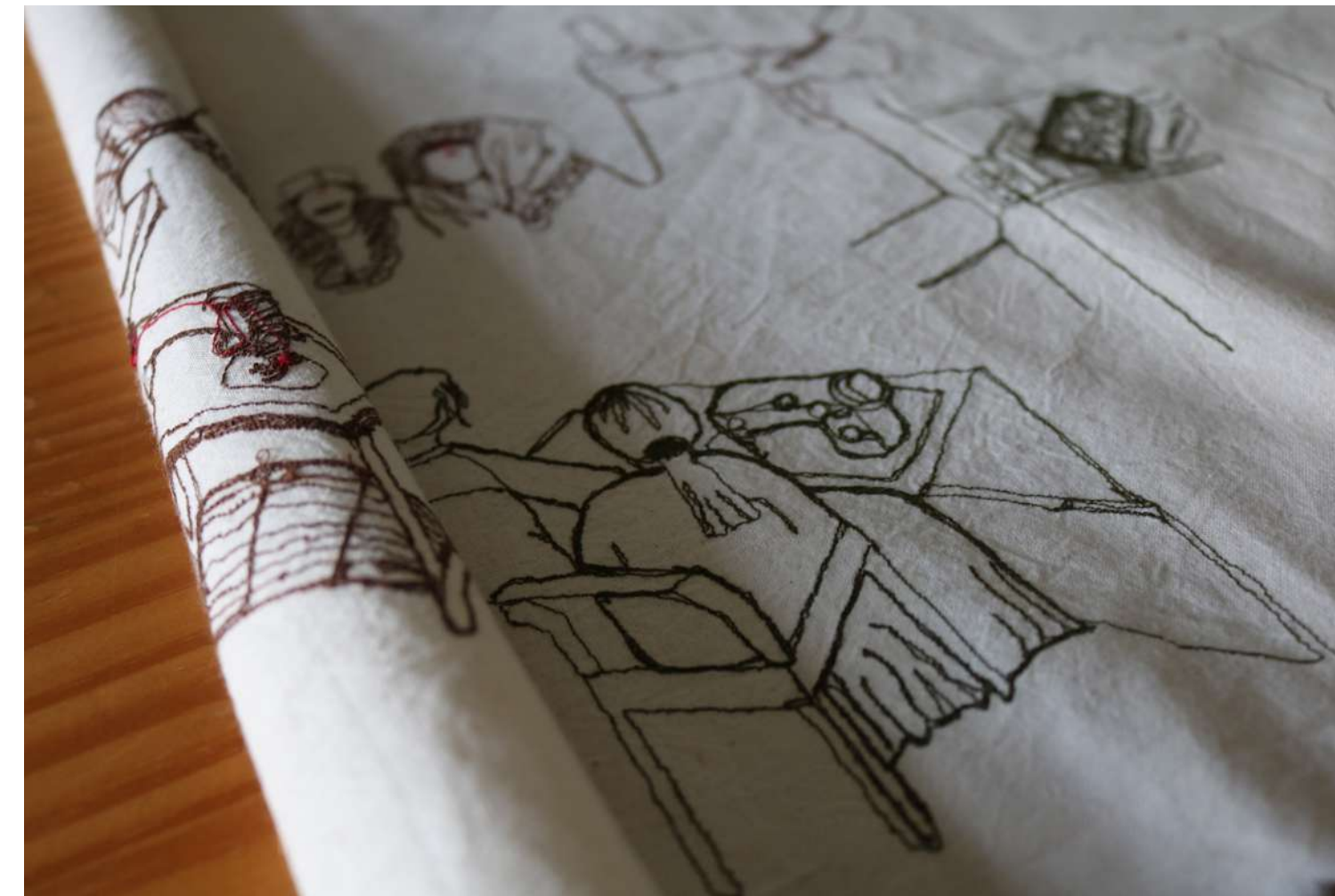
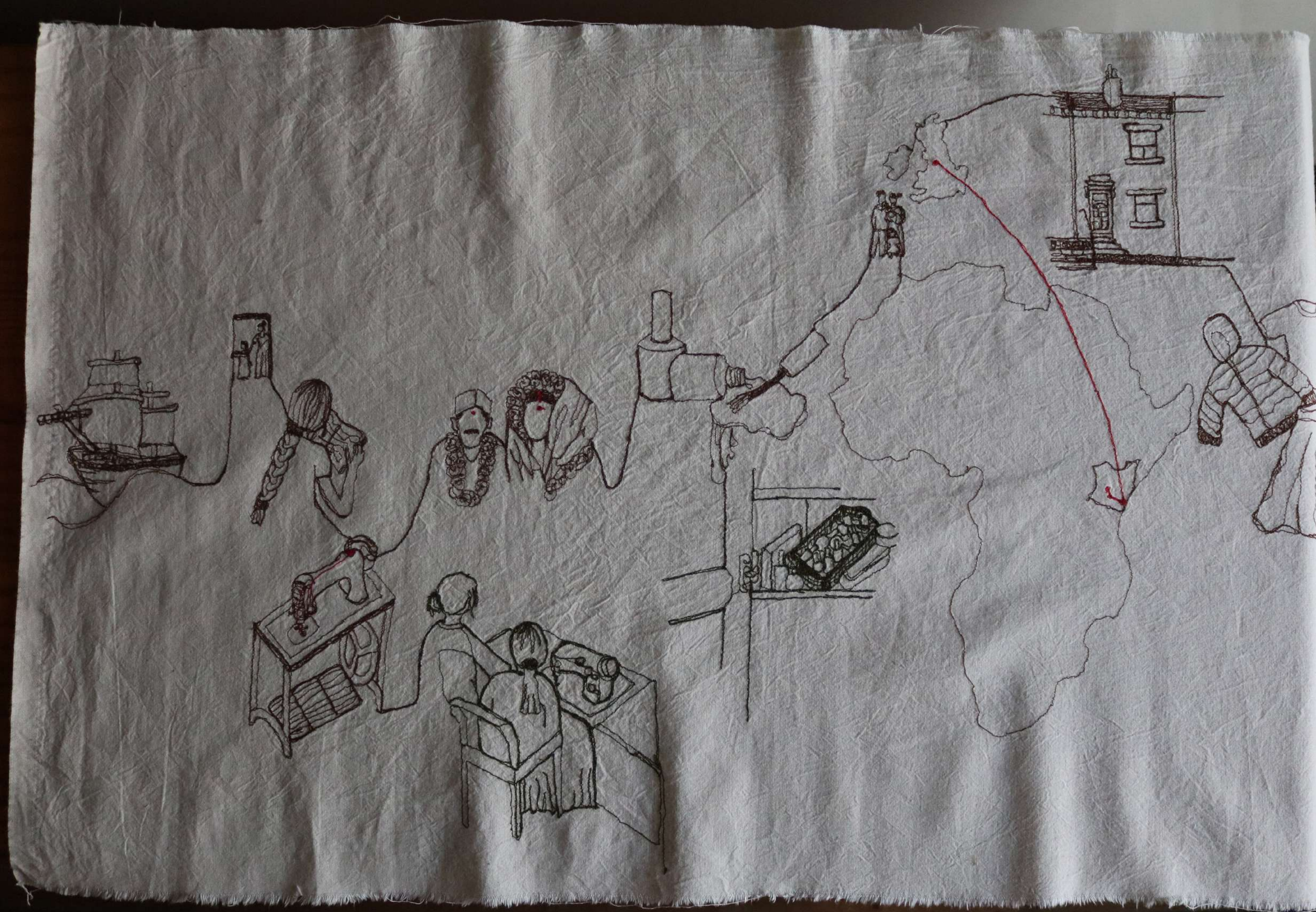

What am I designing?

A place where people can go to **share** their **stories** and turn them into **tangible artwork** to enjoy, with the help of skilled artists and sewers.

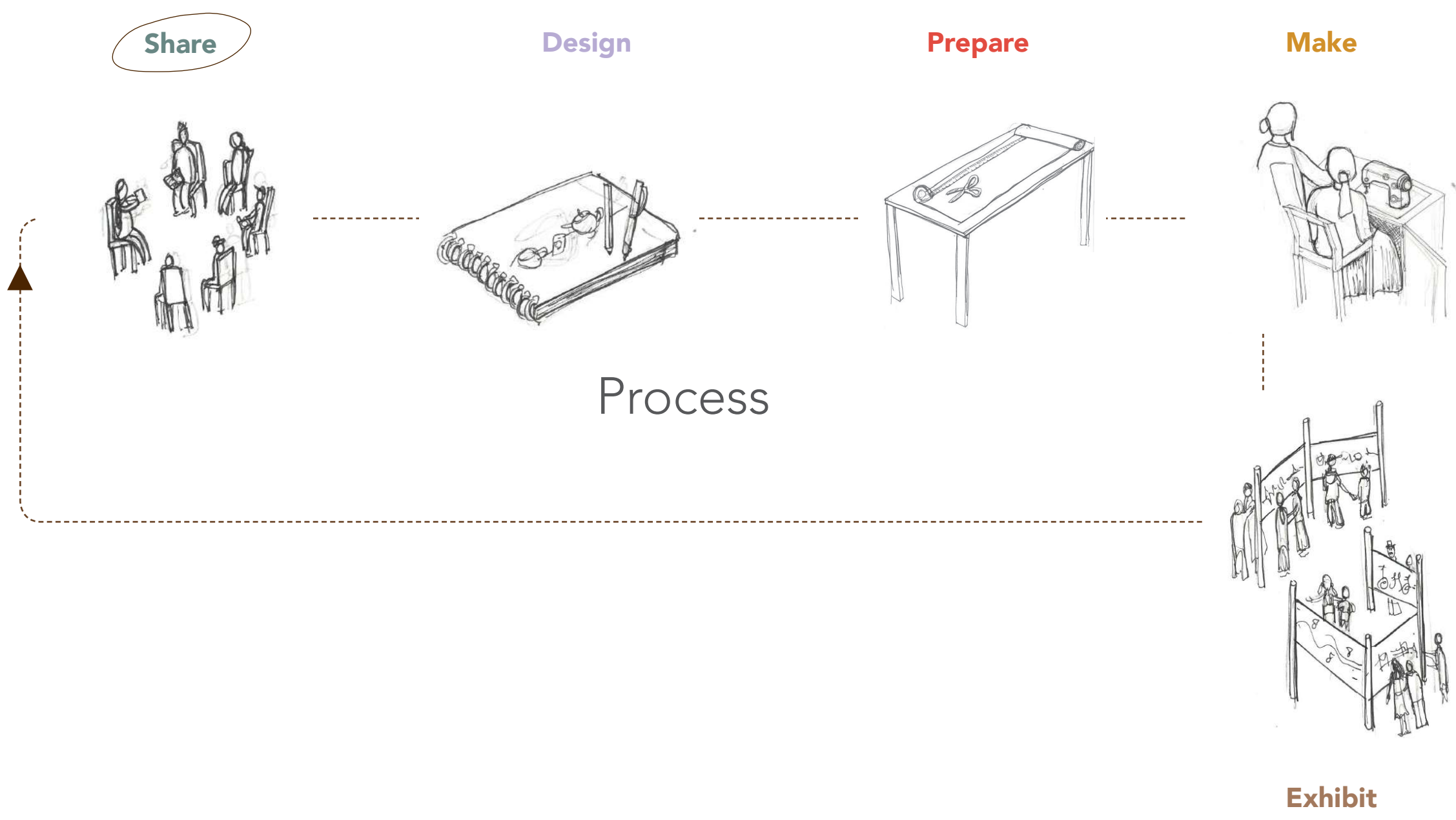

Development: Sketches & Gallery Concept Model

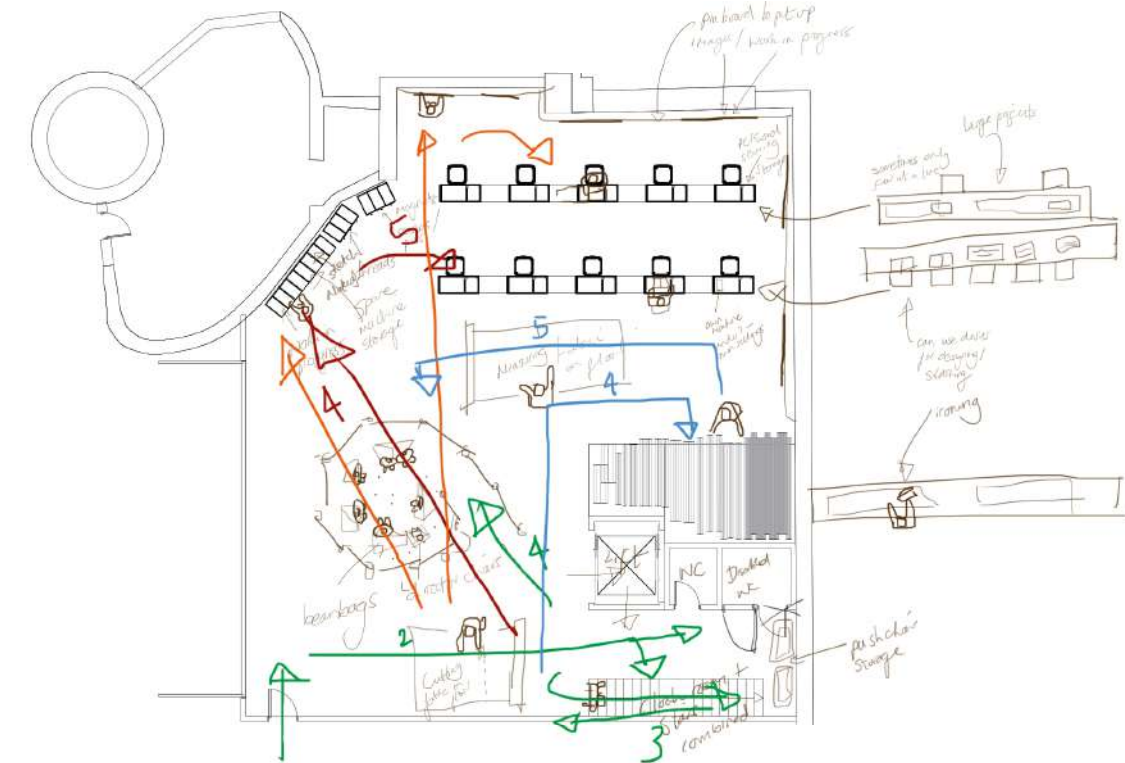
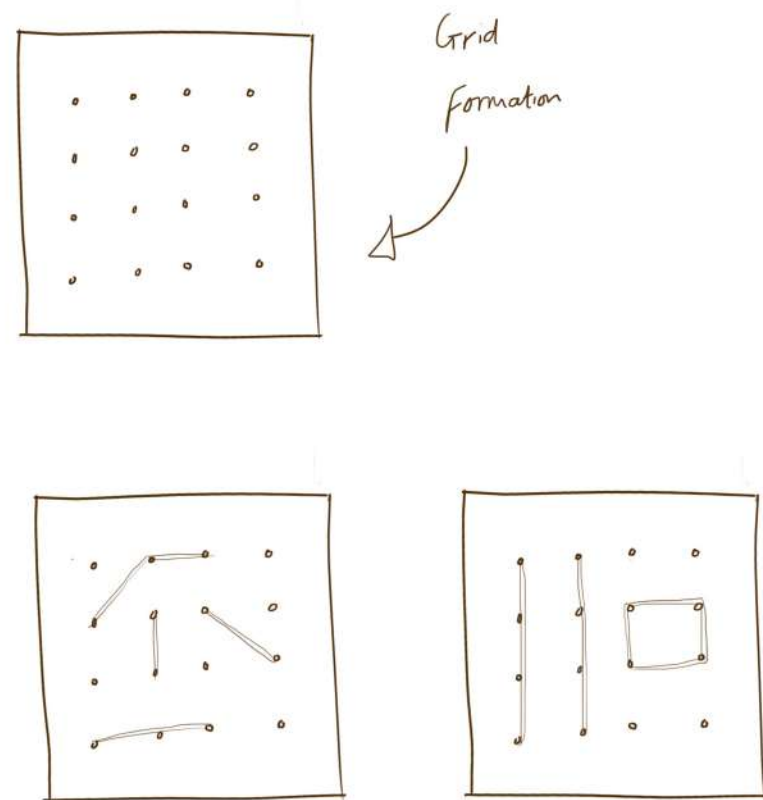
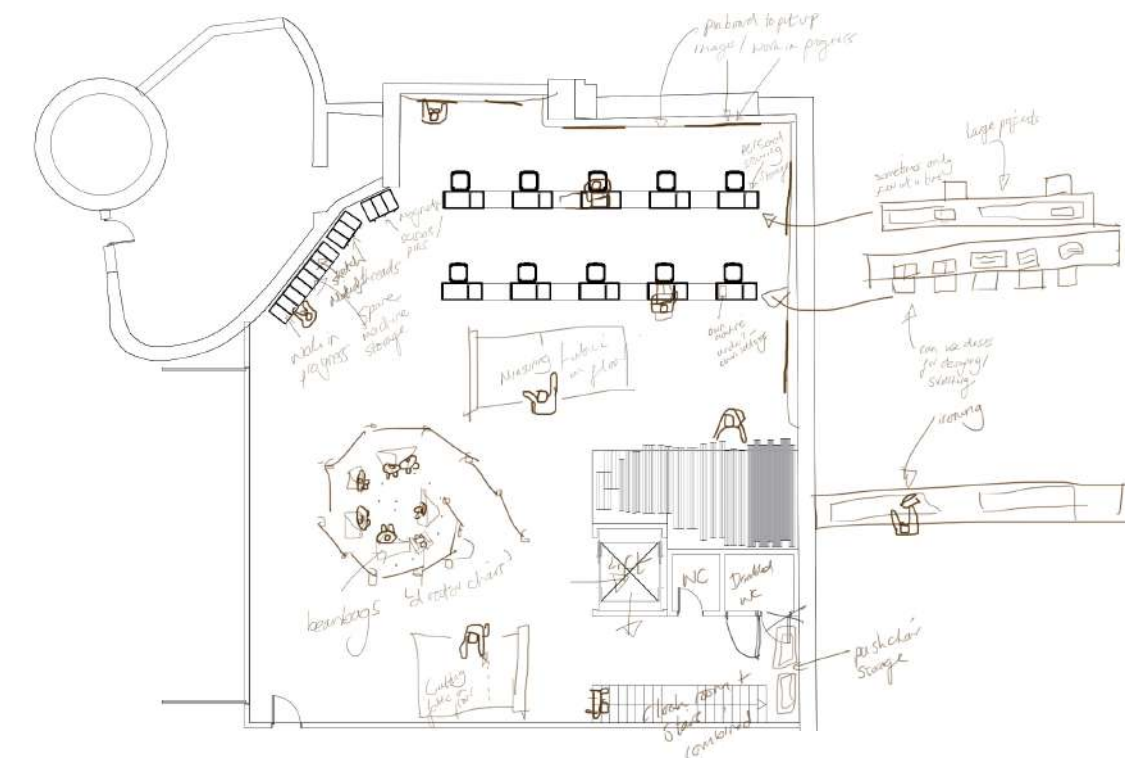

- ① enter
- ② cloakroom/ WC
- ③ coffee
- ④ show
- ④ get sketch stuff
- ⑤ sketch
- ④ Get material
- ⑤ Measure/cut
- ④ get sewing
- ⑤ sew

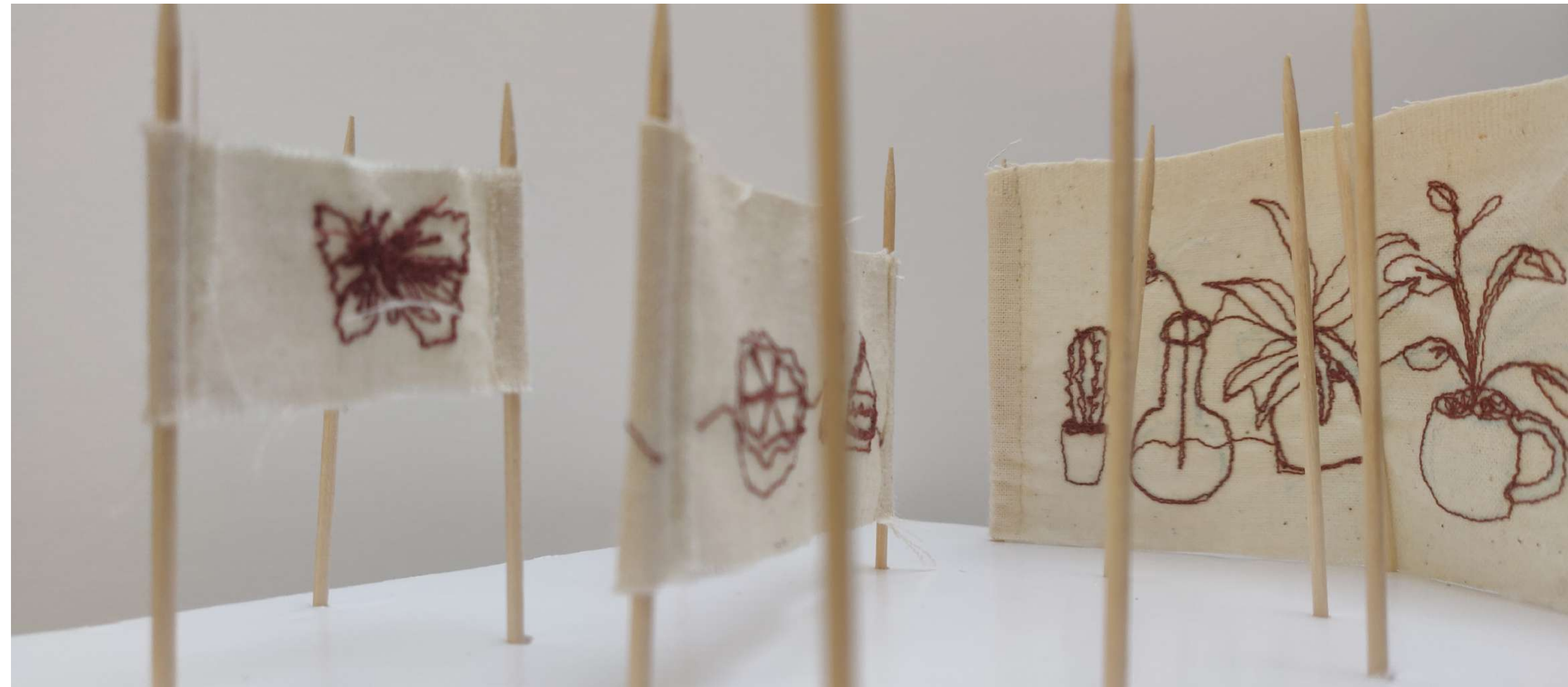
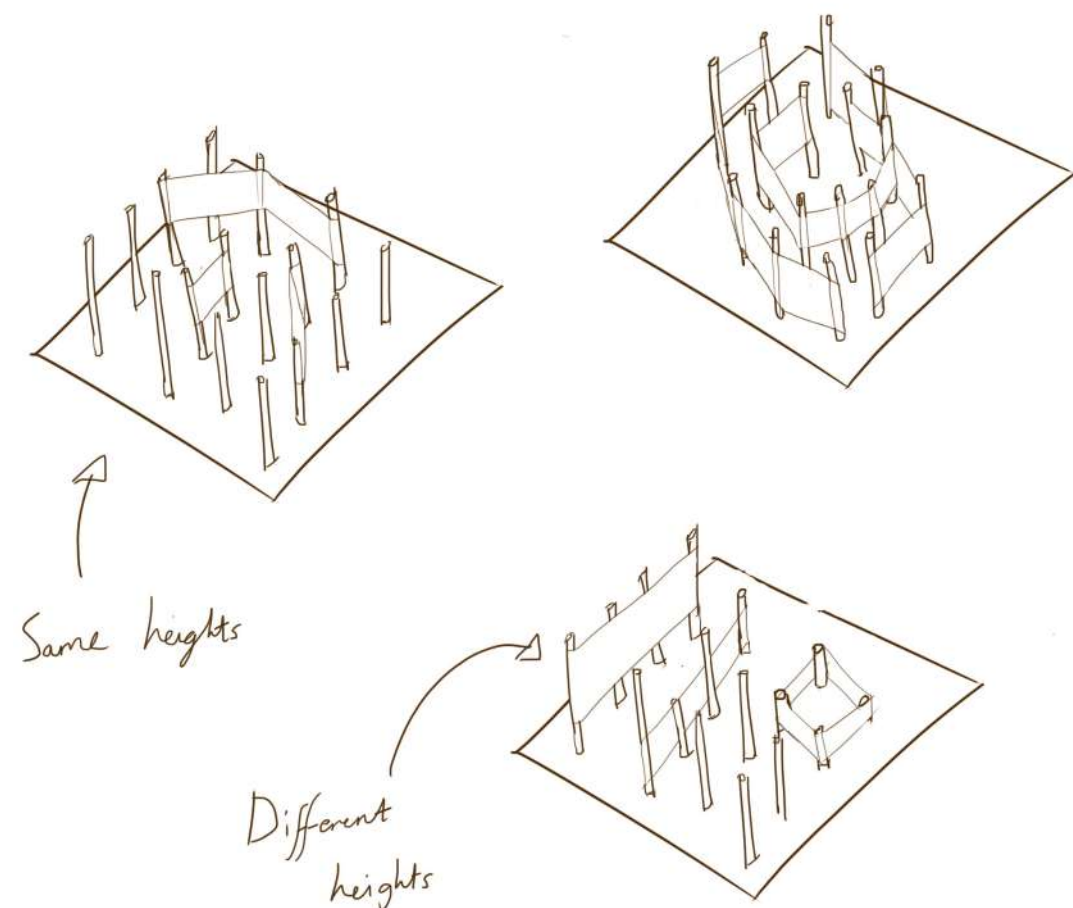

Floor Plans: Functions

1 Share

Ground Floor: This space is formed from the poles being placed in a spiral formation in the grid with material wrapping around it. This allows you to enter into a private and intimate space where you can share your story with a group of people.

Mezzanine: Stories can also be shared in even more of an informal environment over a cup of tea relaxing in the kitchen area.

2 Design

Ground Floor: The multifunctional work station tables can be used to sit and sketch your designs and are where sketching classes can take place.

3 Prepare

Ground Floor: Good preparation plays a key part in getting it right when it comes to sewing. There is plenty of space in this open plan design to **measure, mark, cut and iron** your material. The multifunctional work station has a built in measuring tape along the edge and a panel can be flipped around covered in the perfect material to iron on.

Large rolls can be laid out on the floor and on the work stations which form long tables. Designs can also be pinned up on the walls surrounding the work stations as they are clad with display board material made from recycled plastic

4 Make

Ground Floor: The multifunctional work stations are perfect for sewing long pieces of material like a tapestry. You can also attach a lamp to the desks and store all your pins and threads in the hanging baskets under the tables to personalise your space.

5 Exhibit

Ground Floor: The share space doubles as an exhibition space as the poles can be put into this grid in any formation.

Mezzanine: The mezzanine at the top of the stairs can be used as an exhibition space as well as a balcony to overlook the rest of the work space. The poles can be arranged in any formation making this a flexible space. This can also be used to rent out and run workshops as it is more of a private space. The same sharing pole arrangement can be placed here too.

The Grid

The **600x600mm Fixed Grid** is an integral part of this design; the poles engage with it in multiple ways to create storage and different functional spaces. A grid hierarchy of half of a grid (300x300), a fixed grid (600x600) and a double grid (≈1200x1200) are used to create these. There is also a pole hierarchy of 30mm and 60mm diameter used for different functions such as to construct furniture.

Grid Hierarchy

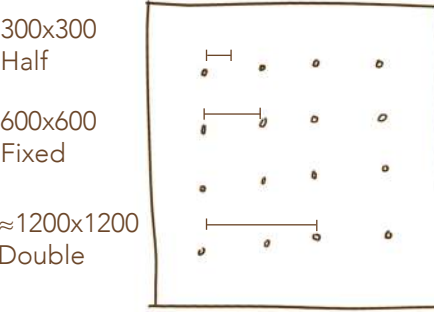

- (A) Cloakroom
- (B) Tools Storage
- (C) Materials Storage
- (D) Pole Storage
- (E) WC
- (F) Disabled WC/Baby Changing
- (G) Lift
- (H) Kitchen

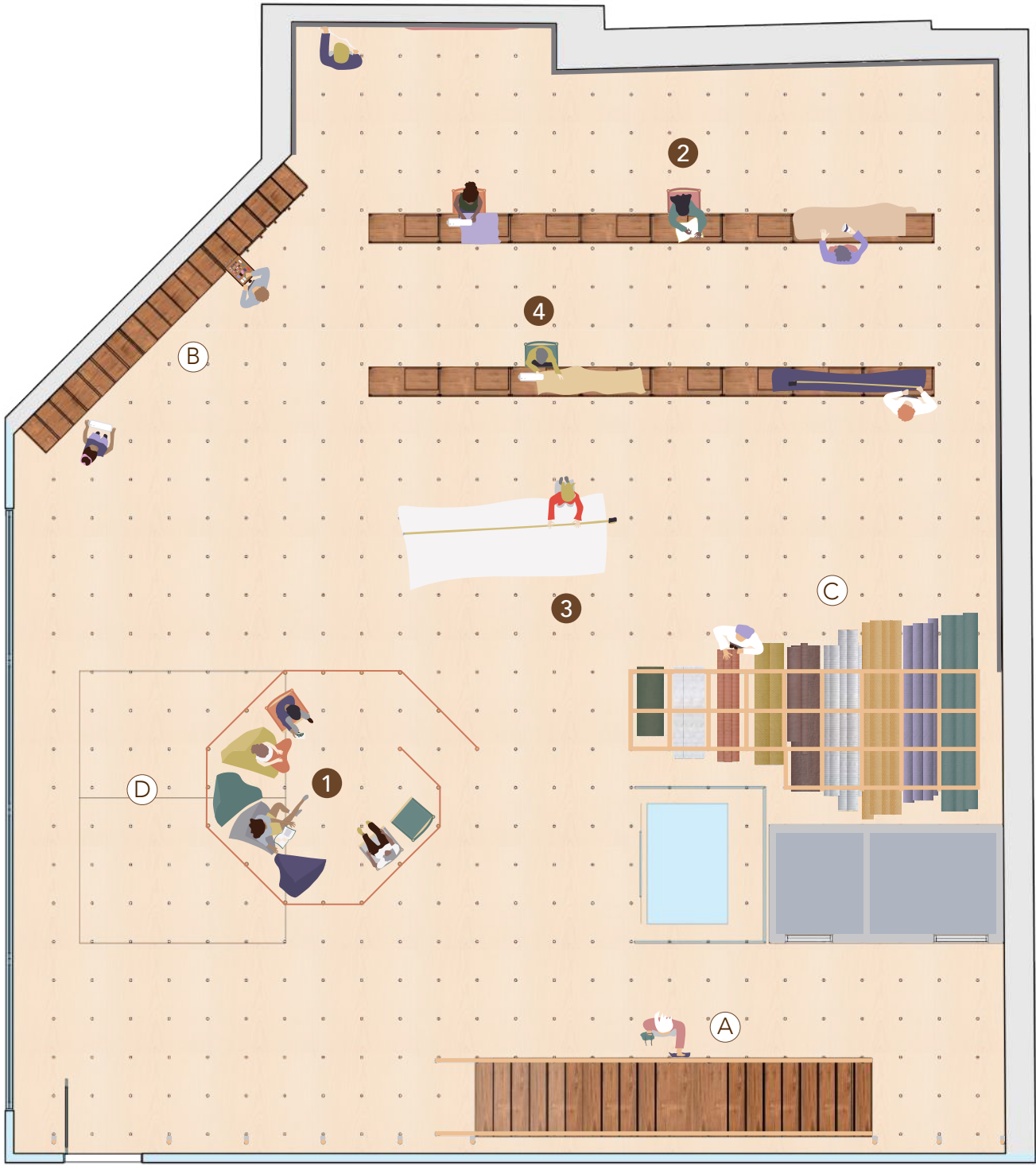

Ground Floor Plan
Share
1:100

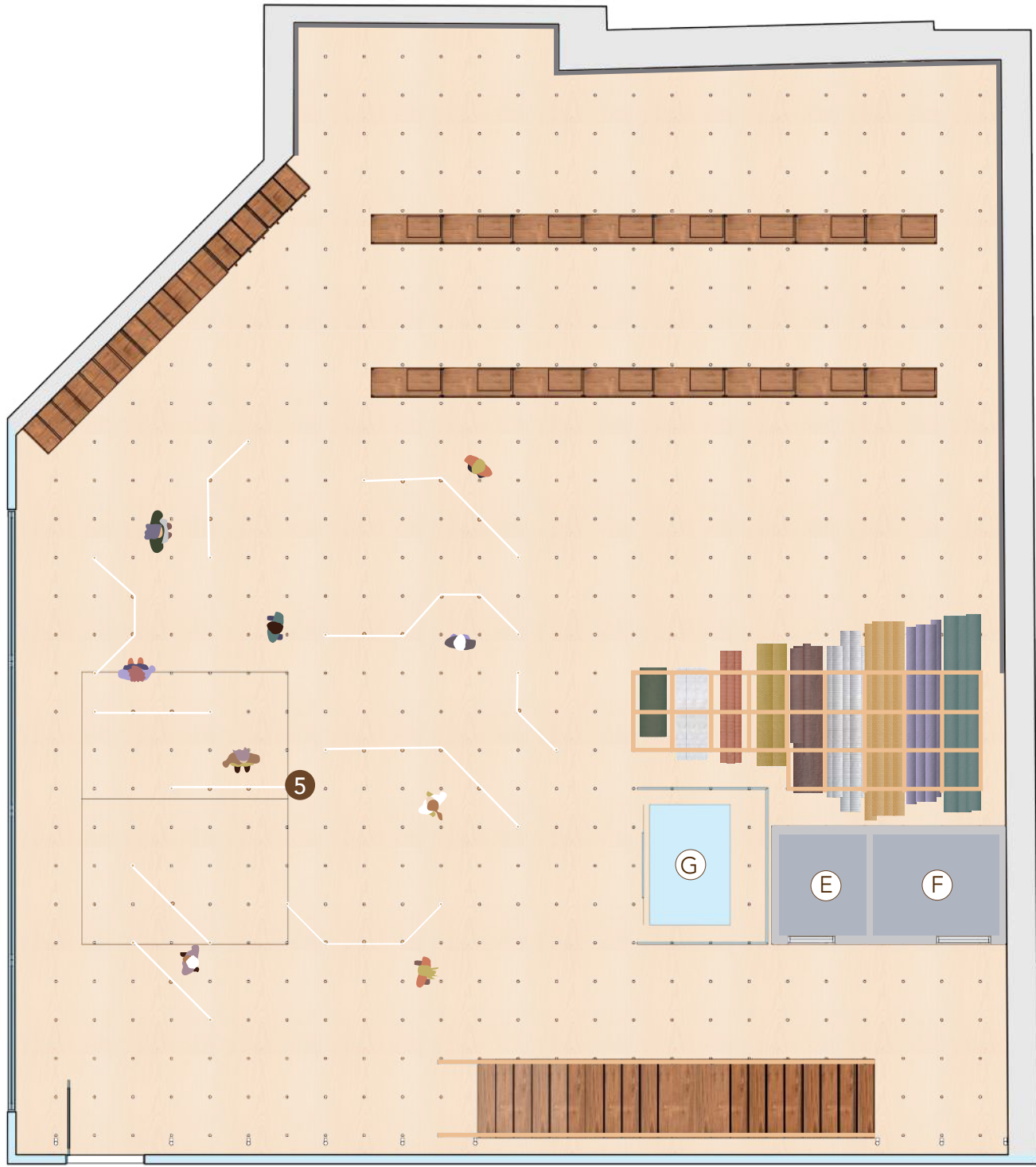

Ground Floor Plan
Exhibit
1:100

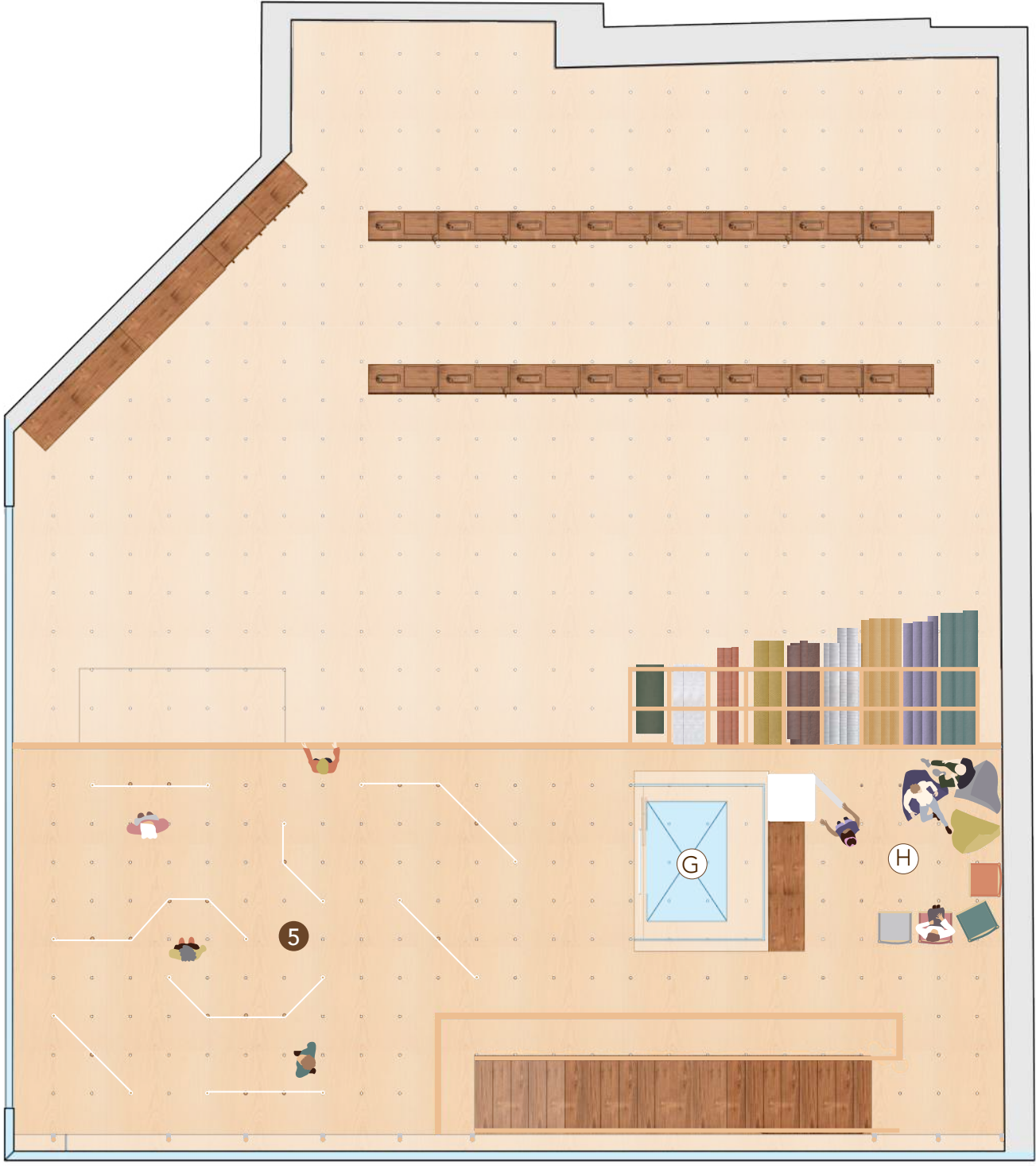

Mezzanine Floor Plan
Share & Exhibit
1:100



Work Station Design:

Padded chair for comfort, can be moved anywhere

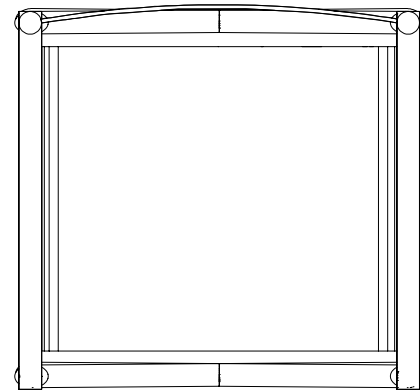

Measuring tape fixed onto the desk

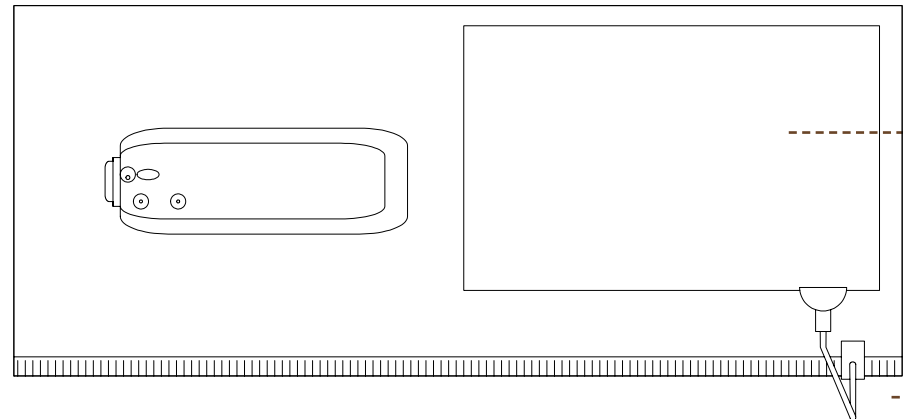
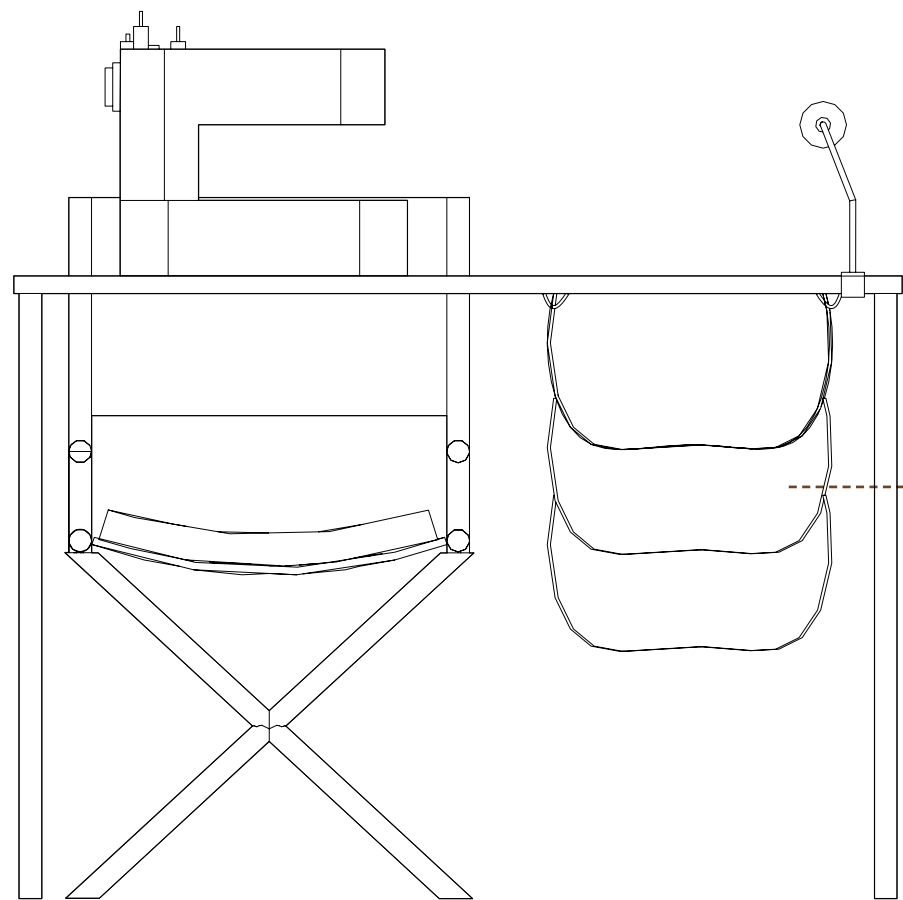

Table section can be flipped around to a surface that can be ironed on

Removable lamp to help with vision sewing and sketching

The desks are placed next to each other to form long surfaces for working with long pieces of fabric



Detachable hanging basket so you can personalise your workspace and keep the desk clear of clutter

Work Stations
Plan
1:10

Work Stations
Elevation
1:10

Section: Work Stations

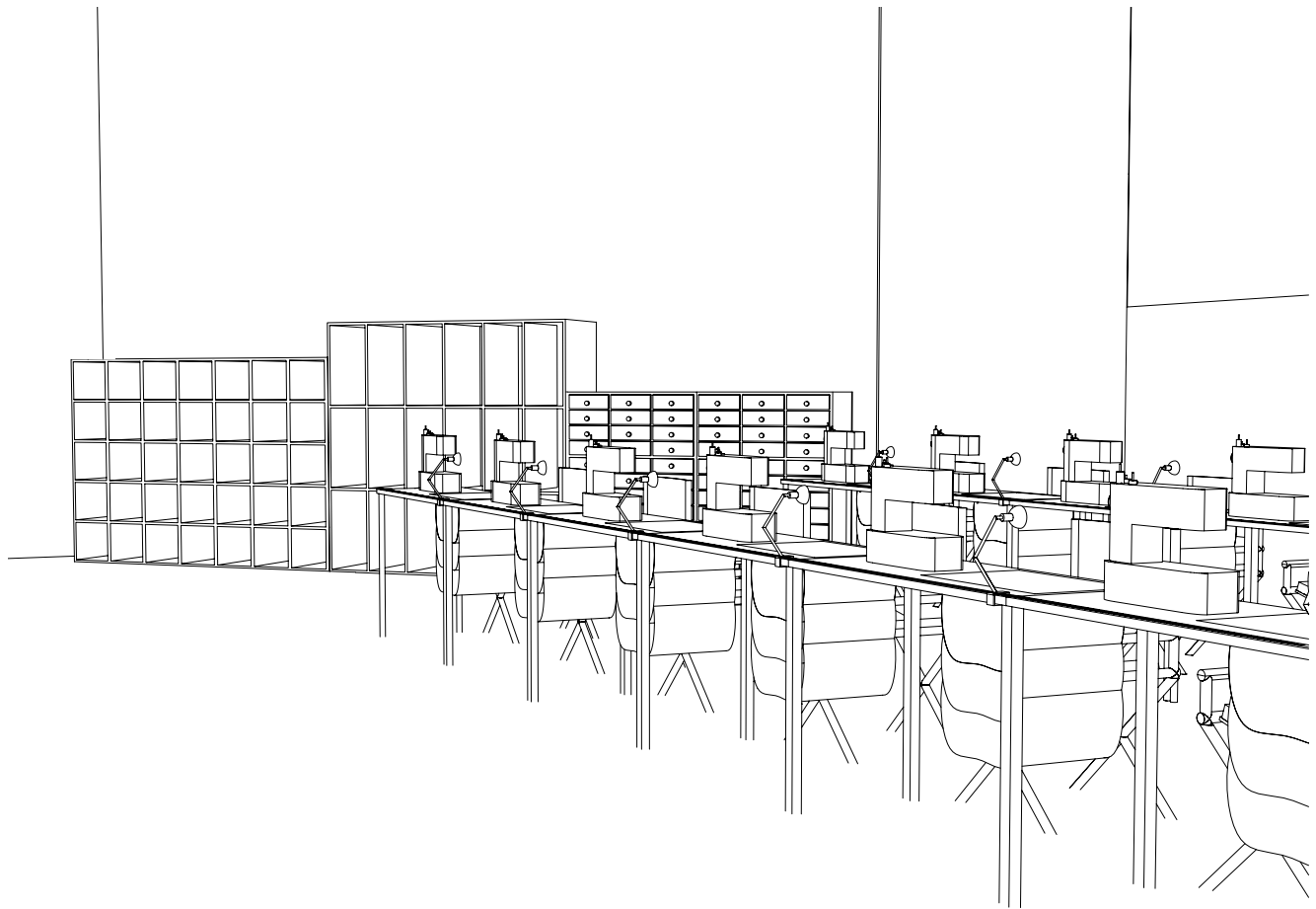
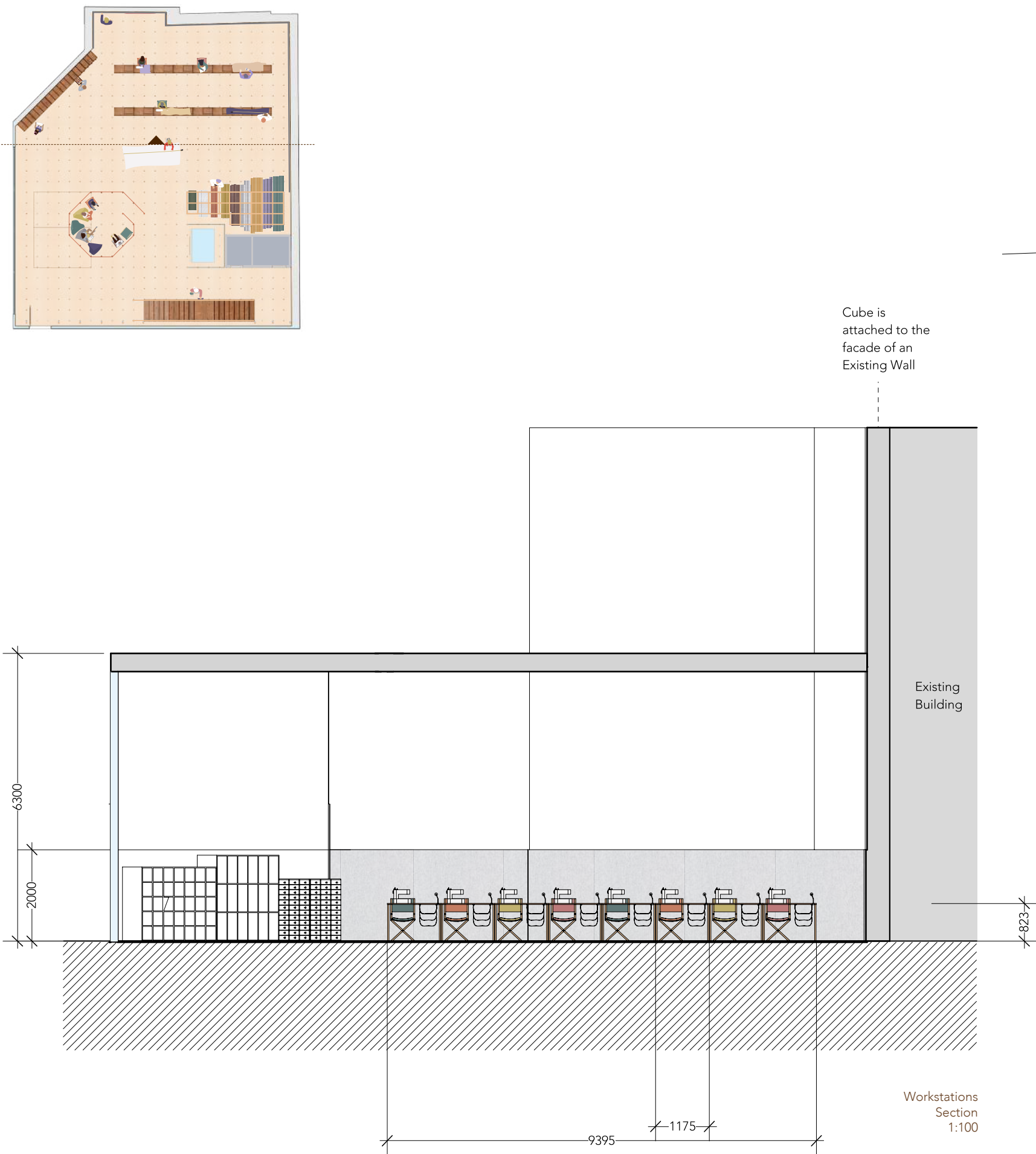

Exhibition Spaces:



Kit of Parts: Pole Construction

1.

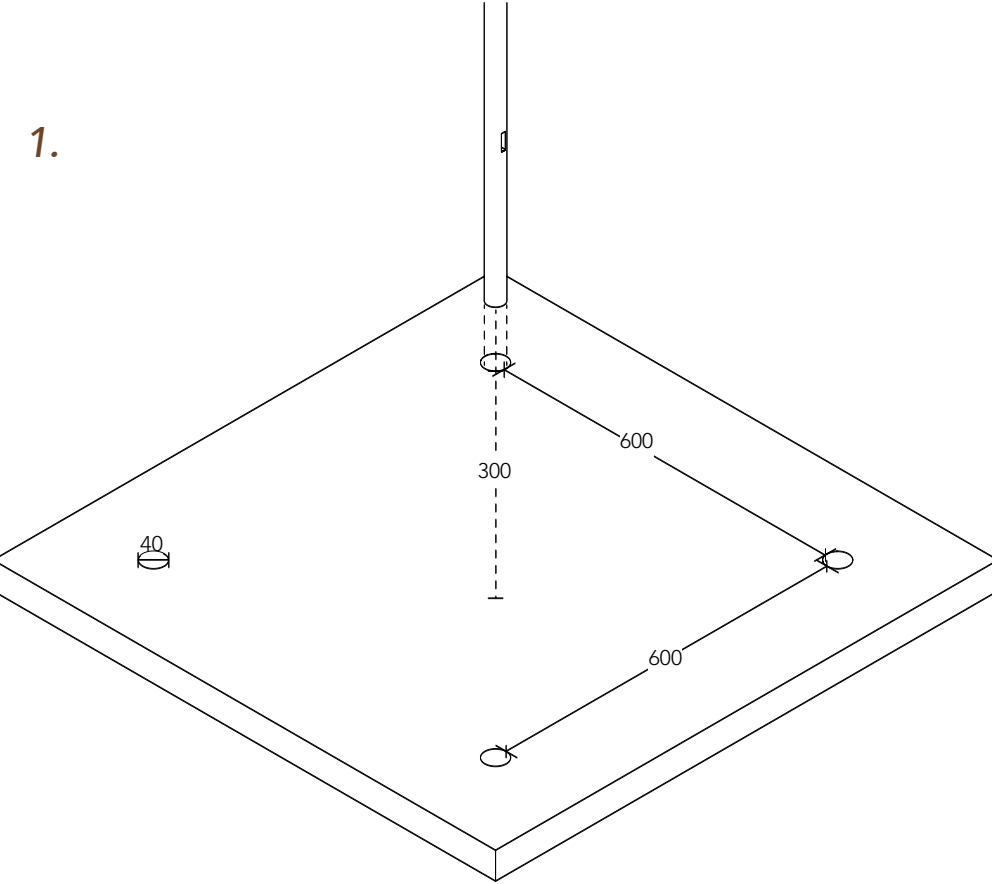

Step 1

Poles are inserted into a the holes into the 600mm x 600mm grid.

The poles are 30mm diameter and inserted into 40mm diameter holes.

The poles are inserted into holes that are 300mm deep.

Step 2

Poles can be connected horizontally by inserting shaped ends into slits in the vertical poles.

Step 3

Poles can be connected vertically by inserting shaped ends into slits in the horizontal poles.

These parts and methods can be used to **construct different elements** in the design: the material storage rack, the stair bannister and exhibition display of the tapestries.

2.

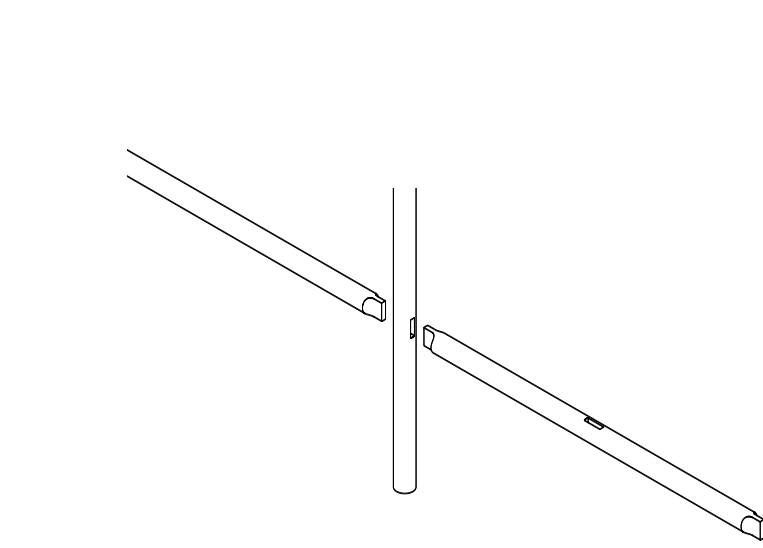

Isometric

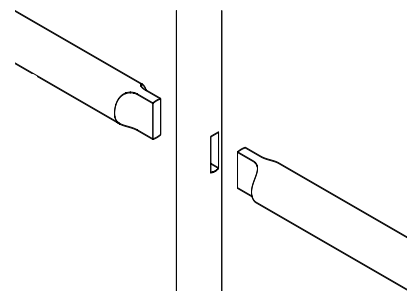

Elevation View

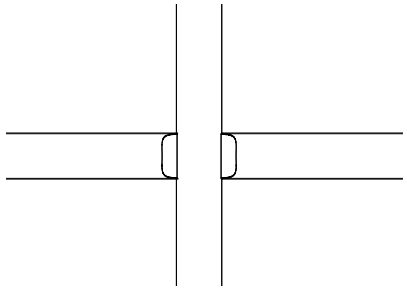

Plan View

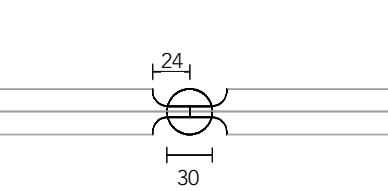

Elevation View

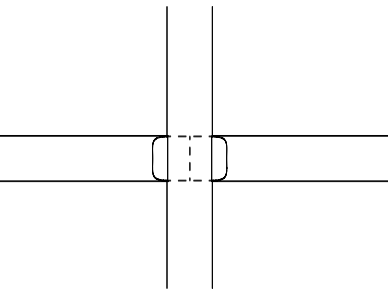

3.

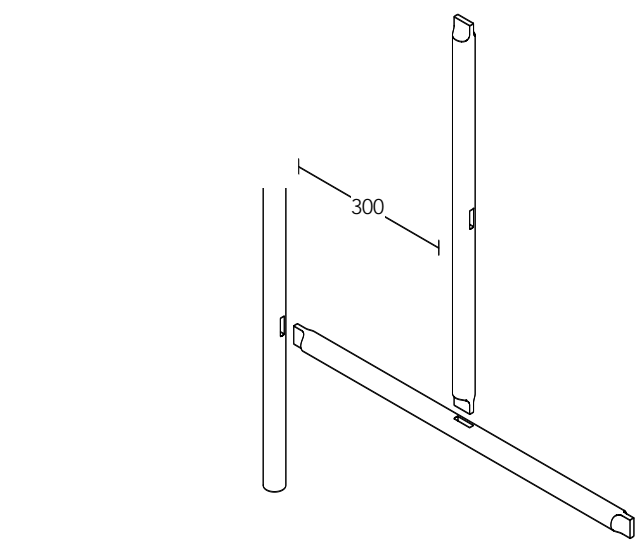

Isometric

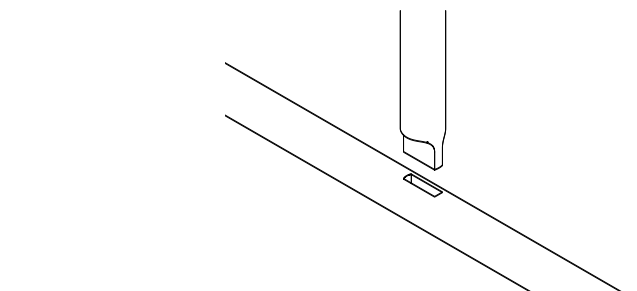

Elevation View

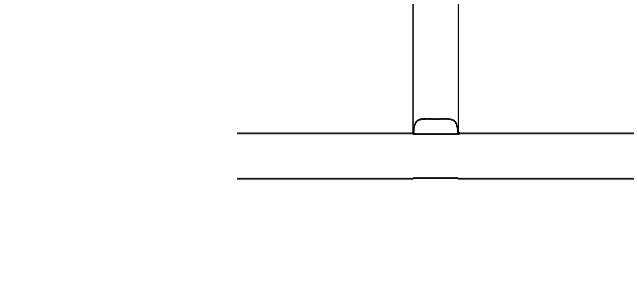

Elevation View

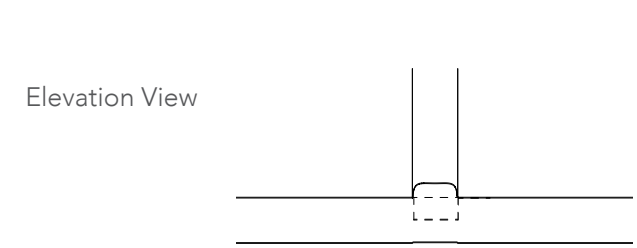

Isometric Drawings
Scale 1:10

Detail drawings
Scale 1:5

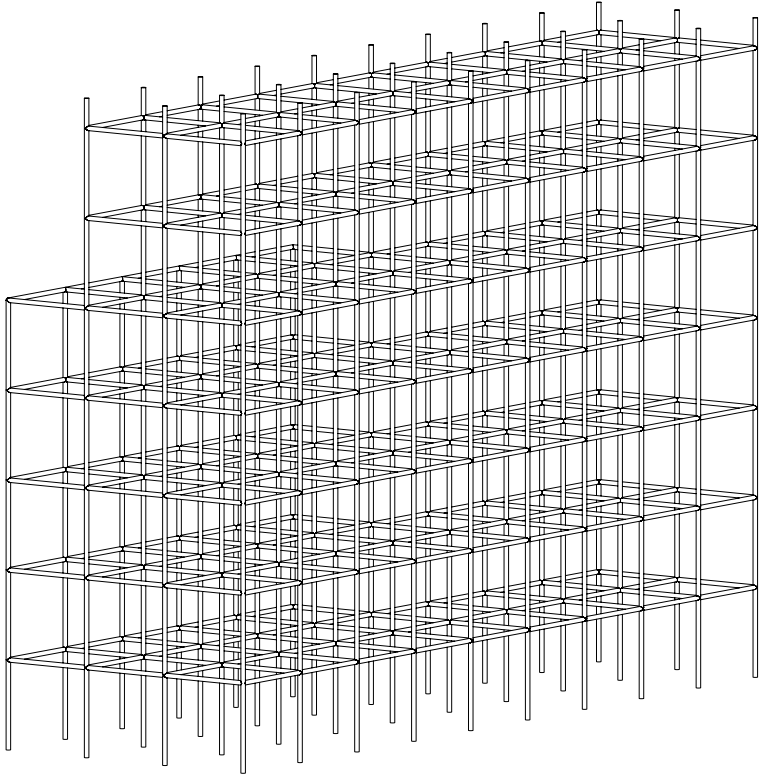

Material Storage Rack

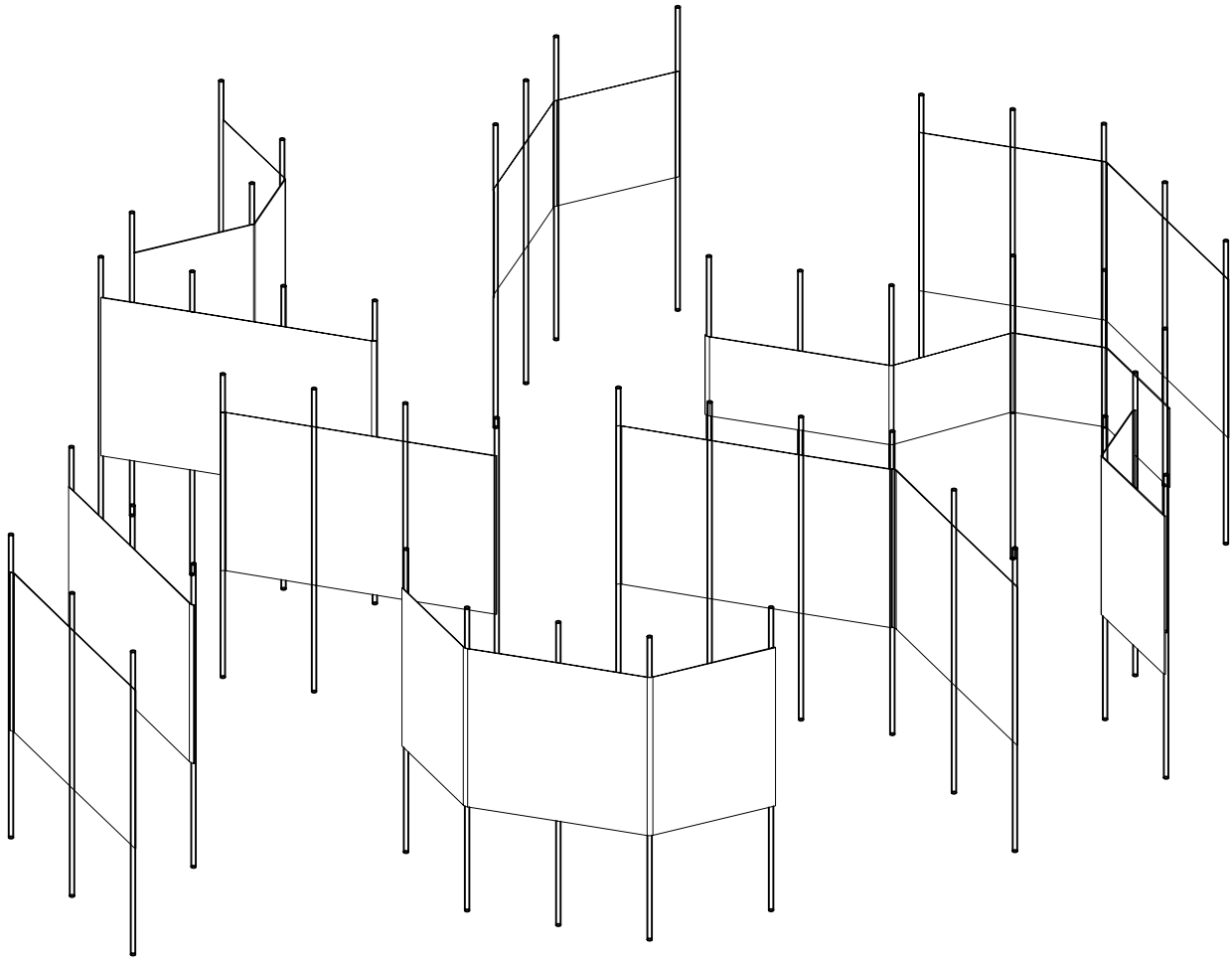

Exhibition Display

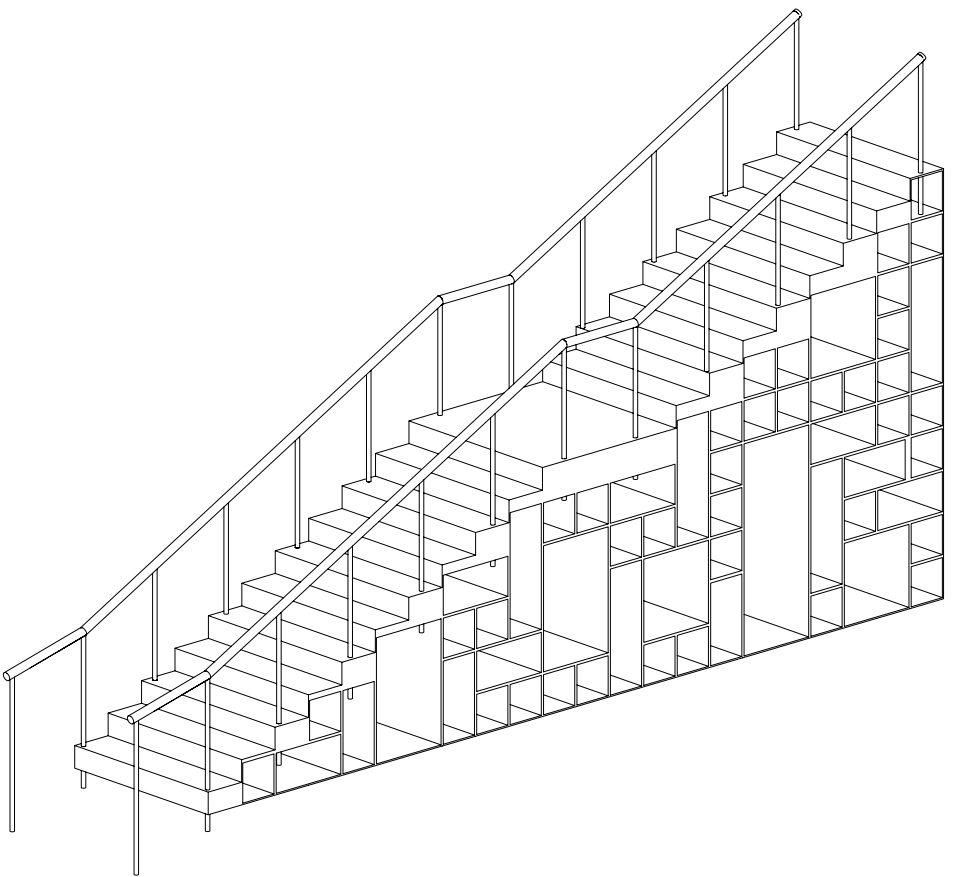

Stair Bannister